

**CITY OF KENEDY, TEXAS  
ORDINANCE 21-09**

**AN ORDINANCE OF THE CITY COUNCIL OF THE CITY OF KENEDY, TEXAS, RATIFYING, EXTENDING AND EXPANDING THE CITY'S EXTRATERRITORIAL JURISDICTION; PROVIDING FOR FILING THIS ORDINANCE AND UPDATING MAP; PROVIDING FOR SAVINGS. REPEALING AND SEVERABILITY; AND ESTABLISHING AN EFFECTIVE DATE**

**WHEREAS**, pursuant to Section 42.021, Local Government Code, the City of Kenedy, Texas (the "City") extends and expands its extraterritorial jurisdiction ("ETJ") to include all of the Property described on Exhibit A attached hereto and incorporated herein for all purposes (the "Property"); and

**WHEREAS**, the City has determined that it will be in the best interests of the City and will benefit the Property if the City extends and expands its ETJ to include all of the Property;

**NOW, THEREFORE, BE IT ORDAINED BY THE CITY COUNCIL OF THE CITY OF KENEDY, TEXAS:**

**Section 1: Recitals Incorporated.** The recitals contained in the preamble of this Ordinance are determined to be true and correct and are hereby adopted as a part of this Ordinance.

**Section 2: ETJ Expanded.** The City of Kenedy, Texas, hereby extends and expands its ETJ to include all of the Property.

**Section 3: Filing of Ordinance and Map.** The City Secretary is directed to file with the County Clerk of Karnes County, Texas, a certified copy of this Ordinance. The map of the City's incorporated boundaries and ETJ shall be updated to reflect the Property as being in the ETJ.

**Section 4: Savings/Repealing.** All provisions of any ordinance in conflict with this Ordinance are hereby repealed to the extent they are in conflict; but such repeal shall not abate any pending prosecution for violation of the repealed ordinance, nor shall the repeal prevent a prosecution from being commenced for any violation if occurring prior to the repeal of the ordinance. Any remaining portions of said ordinances shall remain in full force and effect.

**Section 5. Severability.** Should any section, subsection, sentence, clause, phrase of this Ordinance be declared unconstitutional or invalid by a court of competent jurisdiction, it is expressly provided that any and all remaining portions of this Ordinance shall remain in full force and effect. The City of Kenedy hereby declares that it would have passed this Ordinance, and each section, subsection, sentence, clause or phrase thereof irrespective of the fact that any one or more sections, subsections, sentences, clauses and phrases be declared unconstitutional or invalid. Should any section, subsection, sentence, clause, phrase of this Ordinance be declared unconstitutional or invalid by a court of competent jurisdiction as to any portion of the Property, it is expressly provided that this Ordinance would have still been adopted by the City for the remaining portion of the Property and this Ordinance shall be effective as to any and all remaining portions of the Property.

**Section 6. Effective Date.** This Ordinance shall become effective immediately upon its adoption.

**DULY ADOPTED AND PASSED** by the City Council of the City of Kenedy, Texas, on this 13<sup>th</sup> day of July, 2021.

AYES \_\_\_\_\_

NAYS \_\_\_\_\_

ABSTENTIONS \_\_\_\_\_

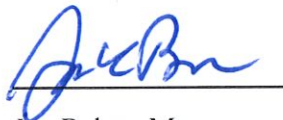

Joe Baker, Mayor  
City of Kenedy,  
Texas

**ATTEST** \_\_\_\_\_



Ruby Beaven, City Secretary



ORDINANCE NO. 21-09



**PROPOSED EXTRATERRITORIAL JURISDICTION - 2458.81 ACRES**

**LEGAL DESCRIPTION:** Being 2574.64 acres of land for the purpose of delineating a Defined Territory for the Proposed Extraterritorial Jurisdiction Limit in Kenedy, Karnes County, Texas:

**BEGINNING** at a 5/8 inch iron rod found for the south corner of that certain PID# 70504 and a southwest corner hereof;

**THENCE** North 46°32'40" West a distance of 1109.31 feet to a point in the east line of U. S. Highway No. 181 for an interior corner hereof;

**THENCE** along the east lines of U. S. Highway No. 181, the following 14 courses:

1. South 07°16'22" East a distance of 1025.72 feet to a point for a corner hereof;
2. South 08°30'05" East a distance of 409.36 feet to a point for a corner hereof;
3. South 06°44'51" East a distance of 1150.24 feet to a point for a corner hereof;
4. South 07°16'54" East a distance of 34.59 feet to a point for a corner hereof;
5. South 06°03'11" East a distance of 78.08 feet to a point for a corner hereof;
6. South 04°46'17" East a distance of 213.12 feet to a point for a corner hereof;
7. South 03°31'35" East a distance of 480.72 feet to a point for a corner hereof;
8. South 47°49'25" East a distance of 70.78 feet to a point for a corner hereof;
9. South 17°03'54" West a distance of 88.19 feet to a point for a corner hereof;
10. South 73°34'13" West a distance of 100.05 feet to a point for a corner hereof;
11. South 23°59'36" West a distance of 41.35 feet to a point for a corner hereof;
12. South 03°26'22" East a distance of 410.84 feet to a point for a corner hereof;
13. South 30°35'16" East a distance of 168.50 feet to a point for a corner hereof;
14. South 02°52'00" East a distance of 85.22 feet to a point for a corner hereof;

**THENCE** South 87°08'00" West a distance of 192.64 feet over and across U. S. Highway No. 181 to a point in the west line of U. S. Highway No. 181, for a corner hereof;

**THENCE** along the west lines of U. S. Highway No. 181, the following 13 courses:

1. North 02°12'13" West a distance of 175.48 feet to a point for a corner hereof;
2. North 00°32'03" West a distance of 319.25 feet to a point for a corner hereof;
3. North 02°36'17" West a distance of 891.51 feet to a point for a corner hereof;
4. North 05°54'18" West a distance of 101.76 feet to a point for a corner hereof;
5. North 05°54'20" West a distance of 533.68 feet to a point for a corner hereof;
6. North 07°05'08" West a distance of 620.50 feet to a point for a corner hereof;
7. North 22°34'17" West a distance of 26.92 feet to a point for a corner hereof;
8. North 07°57'48" West a distance of 1436.39 feet to a point for a corner hereof;
9. North 07°36'02" West a distance of 373.06 feet to a point for a corner hereof;
10. North 05°19'32" West a distance of 539.10 feet to a point for a corner hereof;
11. North 06°38'42" West a distance of 653.18 feet to a point for a corner hereof;
12. North 05°49'03" West a distance of 484.75 feet to a point for a corner hereof;
13. North 03°38'58" West a distance of 48.69 feet to a point in the south line of Farm to Market Road No. 2509 for a corner hereof;

**THENCE** along the east lines of Farm to Market Road No. 2509, the following 10 courses:

1. South 61°42'15" West a distance of 383.14 feet to a point for a corner hereof;
2. South 55°18'49" West a distance of 137.62 feet to a point for a corner hereof;
3. South 48°48'16" West a distance of 109.55 feet to a point for a corner hereof;

P.O. Box 519 ♦ 1004 C Street  
Floresville, TX 78114  
O. (830) 393-8833  
F. (830) 393-3388

4. South 45°38'17" West a distance of 214.25 feet to a point for a corner hereof;
5. South 40°41'16" West a distance of 232.09 feet to a point for a corner hereof;
6. South 31°04'09" West a distance of 73.20 feet to a point for a corner hereof;
7. South 29°23'59" West a distance of 713.11 feet to a point for a corner hereof;
8. South 24°47'56" West a distance of 481.21 feet to a point for a corner hereof;
9. South 13°18'34" West a distance of 339.17 feet to a point for a corner hereof;
10. South 08°56'09" West a distance of 54.84 feet to a point for a corner hereof;

THENCE North 81°33'55" West a distance of 254.67 feet over and across Farm to Market Road No. 2509 to a point in the west line of Farm to Market Road No. 2509 for a corner hereof;

THENCE along the west lines of Farm to Market Road No. 2509, the following 10 courses:

1. North 08°26'05" East a distance of 89.25 feet to a point for a corner hereof;
2. North 16°13'47" East a distance of 184.26 feet to a point for a corner hereof;
3. North 19°37'17" East a distance of 286.31 feet to a point for a corner hereof;
4. North 27°36'37" East a distance of 479.79 feet to a point for a corner hereof;
5. North 33°19'26" East a distance of 306.32 feet to a point for a corner hereof;
6. North 19°25'49" East a distance of 30.97 feet to a point for a corner hereof;
7. North 08°45'50" East a distance of 42.60 feet to a point for a corner hereof;
8. North 35°57'26" East a distance of 430.94 feet to a point for a corner hereof;
9. North 42°44'24" East a distance of 450.98 feet to a point for a corner hereof;
10. North 59°54'26" East a distance of 568.75 feet to a point in the west line of U. S. Highway No. 181, for a corner hereof;

THENCE along the west lines of U. S. Highway No. 181, the following 11 courses:

1. North 27°27'31" East a distance of 131.67 feet to a point for a corner hereof;
2. North 00°33'40" West a distance of 437.60 feet to a point for a corner hereof;
3. North 08°19'48" West a distance of 889.65 feet to a point for a corner hereof;
4. North 07°36'36" West a distance of 573.56 feet to a point for a corner hereof;
5. North 06°36'22" West a distance of 485.21 feet to point for a corner hereof;
6. North 07°21'54" West a distance of 1563.51 feet to a point for a corner hereof;
7. South 82°57'40" West a distance of 33.62 feet to a point for a corner hereof;
8. North 07°23'56" West a distance of 780.00 feet to a point for a corner hereof;
9. North 07°30'21" West a distance of 688.60 feet to a point for a corner hereof;
10. North 08°15'38" West a distance of 722.12 feet to a point for a corner hereof;
11. North 46°04'41" West a distance of 163.24 feet to a point in the south line of Farm to Market Road No. 1145 for an interior corner hereof;

THENCE South 89°29'54" West a distance of 2688.26 feet along the south line of Farm to Market Road No. 1145 to a point for a corner hereof;

THENCE North 00°33'18" West a distance of 159.98 feet over and across Farm to Market Road No. 1145 to a point in the north line of Farm to Market Road No. 1145 for a corner hereof;

THENCE North 89°50'42" East a distance of 2665.02 feet along the north line of Farm to Market Road No. 1145 to a point in the west line of U. S. Highway No. 181 for a corner hereof;

THENCE along the west lines of U. S. Highway No. 181, the following 2 courses:

1. North 30°28'54" East a distance of 165.47 feet to a point for a corner hereof;
2. North 06°57'12" West a distance of 898.50 feet to a point for a corner hereof;

THENCE South 88°42'10" West a distance of 134.78 feet to a point for a corner hereof;

THENCE North 45°29'30" West a distance of 676.10 feet to a point for a corner hereof;

THENCE North 76°30'49" East a distance of 215.00 feet to a point for a corner hereof;

THENCE North 05°40'15" West a distance of 158.58 feet to a point for a corner hereof;

THENCE North 81°37'20" East a distance of 328.93 feet to a point for a corner hereof;

THENCE North 11°04'59" West a distance of 43.22 feet to a point for a corner hereof;

THENCE North 46°53'05" West a distance of 559.53 feet to a point for a corner hereof;

THENCE North 85°13'01" East a distance of 93.78 feet to a point for a corner hereof;

THENCE North 03°47'52" West a distance of 213.51 feet to a point for a corner hereof;

THENCE North 86°57'38" West a distance of 28.66 feet to a point for a corner hereof;

THENCE North 02°58'17" West a distance of 486.47 feet to a point for a corner hereof;

THENCE North 45°46'30" West a distance of 304.68 feet to a point in the southeast line of State Highway No. 72 for a corner hereof;

THENCE South 43°38'34" West a distance of 1640.12 feet along the southeast line of State Highway No. 72 to a point for a corner hereof;

THENCE South 35°00'45" East a distance of 338.23 feet to a point for a corner hereof;

THENCE South 45°33'56" West a distance of 179.15 feet to a point for a corner hereof;

THENCE South 02°55'09" East a distance of 73.17 feet to a point for a corner hereof;

THENCE South 51°15'40" West a distance of 62.92 feet to a point for a corner hereof;

THENCE North 58°13'53" West a distance of 85.41 feet to a point for a corner hereof;

THENCE South 49°51'13" West a distance of 145.96 feet to a point for a corner hereof;

THENCE North 36°29'58" West a distance of 282.87 feet to a point in the southeast line of State Highway No. 72 to a point for a corner hereof;

THENCE along the southeast lines of State Highway No. 72, the following 10 courses:

1. South 42°41'13" West a distance of 125.36 feet to a point for a corner hereof;
2. South 16°58'48" West a distance of 20.41 feet to a point for a corner hereof;
3. South 41°39'24" West a distance of 694.12 feet to a point for a corner hereof;
4. South 44°06'42" West a distance of 30.66 feet to a point for a corner hereof;
5. South 44°06'41" West a distance of 523.24 feet to a point for a corner hereof;
6. South 43°30'43" West a distance of 517.57 feet to a point for a corner hereof;
7. South 45°29'20" West a distance of 279.35 feet to a point for a corner hereof;
8. South 56°36'26" West a distance of 202.47 feet to a point for a corner hereof;
9. South 44°02'12" West a distance of 219.31 feet to a point for a corner hereof;
10. South 41°47'36" West a distance of 200.63 feet to a point for a corner hereof;

THENCE North 48°12'24" West a distance of 109.22 feet over and across State Highway No. 72 to a point in the northwest line of State Highway No. 72 for a corner hereof;

THENCE along the northwest lines of State Highway No. 72, the following 4 courses:

1. North 44°26'24" East a distance of 87.31 feet to a point for a corner hereof;
2. North 43°55'53" East a distance of 919.57 feet to a point for a corner hereof;
3. North 44°06'21" East a distance of 864.86 feet to a point for a corner hereof;
4. North 44°29'36" East a distance of 768.28 feet to a point for a corner hereof;

THENCE North 68°53'40" West a distance of 321.79 feet to a point for a corner hereof;

THENCE North 28°45'12" East a distance of 796.15 feet over and across Farm to Market Road No. 2102 to a point in the northeast line of Farm to Market Road No. 2102 for a corner hereof;

THENCE North 70°45'05" West a distance of 911.31 feet along the northeast line of Farm to Market Road No. 2102 to a point for a corner hereof;

THENCE North 27°11'14" East a distance of 978.95 feet to a point for a corner hereof;

THENCE South 52°17'35" East a distance of 26.94 feet to a point for a corner hereof;

THENCE North 26°57'59" East a distance of 2247.44 feet to a point for a corner hereof;

THENCE South 88°22'09" East a distance of 146.66 feet to a point for a corner hereof;

THENCE South 83°58'22" East a distance of 202.89 feet to a point for a corner hereof;

THENCE South 10°32'25" East a distance of 848.62 feet to a point for a corner hereof;

THENCE North 82°01'07" West a distance of 192.52 feet to a point for a corner hereof;

THENCE South 47°03'27" West a distance of 148.73 feet to a point for a corner hereof;

THENCE South 02°35'13" East a distance of 202.27 feet to a point in the northeast line of Bellaire Boulevard for a corner hereof;

THENCE along the northeast lines of Bellaire Boulevard, the following 3 courses:

THENCE South 07°07'01" East a distance of 145.17 feet to a point for a corner hereof;

THENCE South 41°21'23" East a distance of 144.98 feet to a point for a corner hereof;

THENCE South 48°40'42" East a distance of 504.15 feet to a point for a corner hereof;

THENCE North 50°29'46" East a distance of 408.44 feet to a point for a corner hereof;

THENCE North 00°41'06" East a distance of 1520.07 feet over and across U. S. Highway No. 181 to a point for a corner hereof;

THENCE North 68°42'43" East a distance of 30.81 feet over and across U. S. Highway No. 181 to a point for a corner hereof;

THENCE North 54°04'38" East a distance of 31.41 feet over and across U. S. Highway No. 181 to a point for a corner hereof;

THENCE North 41°18'19" East a distance of 278.28 feet to a point for a corner hereof;

THENCE North 47°37'40" East a distance of 665.79 feet to a point for a corner hereof;

THENCE North 45°54'14" West a distance of 1277.56 feet over and across U. S. Highway No. 181 to a point for a corner hereof;

THENCE South 11°23'02" West a distance of 513.01 feet over and across U. S. Highway No. 181 to a point for a corner hereof;



THENCE South 39°54'12" West a distance of 606.90 feet to a point for a corner hereof;  
THENCE South 15°17'40" East a distance of 73.23 feet to a point for a corner hereof;  
THENCE North 68°32'31" West a distance of 90.65 feet to a point for a corner hereof;  
THENCE South 73°29'52" West a distance of 29.11 feet to a point for a corner hereof;  
THENCE South 50°29'40" West a distance of 66.86 feet to a point for a corner hereof;  
THENCE South 32°32'37" West a distance of 109.84 feet to a point for a corner hereof;  
THENCE South 42°16'40" West a distance of 76.42 feet to a point for a corner hereof;  
THENCE South 28°01'57" West a distance of 50.14 feet to a point for a corner hereof;  
THENCE South 33°40'42" West a distance of 53.27 feet to a point for a corner hereof;  
THENCE South 19°20'09" West a distance of 70.06 feet to a point for a corner hereof;  
THENCE South 19°20'09" West a distance of 76.74 feet to a point for a corner hereof;  
THENCE South 39°14'05" West a distance of 109.37 feet to a point for a corner hereof;  
THENCE South 52°16'19" West a distance of 82.81 feet to a point for a corner hereof;  
THENCE South 71°32'24" West a distance of 130.34 feet to a point for a corner hereof;  
THENCE South 74°55'26" West a distance of 55.79 feet to a point for a corner hereof;  
THENCE South 78°19'11" West a distance of 93.72 feet to a point for a corner hereof;  
THENCE South 87°08'23" West a distance of 100.11 feet to a point for a corner hereof;  
THENCE North 85°10'29" West a distance of 106.50 feet to a point for a corner hereof;  
THENCE North 81°59'37" West a distance of 66.73 feet to a point for a corner hereof;  
THENCE North 70°00'51" West a distance of 102.58 feet to a point for a corner hereof;  
THENCE North 60°19'10" West a distance of 83.37 feet to a point for a corner hereof;  
THENCE North 50°28'32" West a distance of 49.66 feet to a point for a corner hereof;  
THENCE North 48°28'04" West a distance of 56.67 feet to a point for a corner hereof;  
THENCE North 31°01'09" West a distance of 39.45 feet to a point for a corner hereof;  
THENCE North 44°21'44" West a distance of 133.01 feet to a point for a corner hereof;  
THENCE North 64°17'10" West a distance of 8.92 feet to a point for a corner hereof;  
THENCE North 40°39'32" West a distance of 95.05 feet to a point for a corner hereof;  
THENCE North 47°48'20" West a distance of 73.09 feet to a point for a corner hereof;  
THENCE North 05°01'36" West a distance of 108.92 feet to a point for a corner hereof;

THENCE North 11°48'50" West a distance of 2863.52 feet to a point for a corner hereof;

THENCE North 42°44'03" East a distance of 840.80 feet to a point for a corner hereof;

THENCE North 43°11'53" West a distance of 503.99 feet to a point for a corner hereof;

THENCE North 45°10'56" East a distance of 408.05 feet to a point in the southwest line of U. S. Highway No. 181 for a corner hereof;

THENCE along the southwest lines of U. S. Highway No. 181, the following 9 courses:

1. North 45°44'20" West a distance of 123.80 feet to a point for a corner hereof;
2. North 45°16'15" West a distance of 288.28 feet to a point for a corner hereof;
3. North 44°00'56" West a distance of 282.64 feet to a point for a corner hereof;
4. North 45°30'57" West a distance of 289.42 feet to a point for a corner hereof;
5. North 45°01'25" West a distance of 287.14 feet to a point for a corner hereof;
6. North 43°53'40" West a distance of 229.14 feet to a point for a corner hereof;
7. North 26°06'33" West a distance of 383.98 feet to a point for a corner hereof;
8. North 23°39'07" West a distance of 428.70 feet to a point for a corner hereof;
9. North 23°23'35" West a distance of 369.44 feet to a point for a corner hereof;

THENCE North 66°09'11" East a distance of 141.86 feet over and across U. S. Highway No. 181 to a point in the northeast line of U. S. Highway No. 181 for a corner hereof;

THENCE along the northeast lines of U. S. Highway No. 181, the following 16 courses:

1. South 23°50'49" East a distance of 249.46 feet to a point for a corner hereof;
2. South 23°50'49" East a distance of 480.03 feet to a point for a corner hereof;
3. South 23°50'49" East a distance of 108.52 feet to a point for a corner hereof;
4. South 24°10'19" East a distance of 88.35 feet to a point for a corner hereof;
5. South 34°25'36" East a distance of 59.95 feet to a point for a corner hereof;
6. South 34°25'36" East a distance of 260.03 feet to a point for a corner hereof;
7. South 34°58'34" East a distance of 211.47 feet to a point for a corner hereof;
8. South 45°42'08" East a distance of 174.43 feet to a point for a corner hereof;
9. South 50°14'43" East a distance of 89.60 feet to a point for a corner hereof;
10. South 45°59'04" East a distance of 148.11 feet to a point for a corner hereof;
11. South 45°59'04" East a distance of 176.09 feet to a point for a corner hereof;
12. South 46°14'03" East a distance of 83.25 feet to a point for a corner hereof;
13. South 46°17'19" East a distance of 306.87 feet to a point for a corner hereof;
14. South 46°17'19" East a distance of 407.74 feet to a point for a corner hereof;
15. South 46°17'19" East a distance of 28.92 feet to a point for a corner hereof;
16. South 44°41'11" East a distance of 43.92 feet to a point for a corner hereof;

THENCE North 48°23'50" East a distance of 469.25 feet to a point for a corner hereof;

THENCE South 47°37'21" East a distance of 99.84 feet to a point for a corner hereof;

THENCE South 44°54'34" West a distance of 492.89 feet to a point in the northeast line of U. S. Highway No. 181 for a corner hereof;

THENCE South 41°09'40" East a distance of 119.97 feet along the northeast line of U. S. Highway No. 181 to a point for a corner hereof;

THENCE North 43°30'15" East a distance of 1234.31 feet to a point for a corner hereof;

THENCE South 47°04'21" East a distance of 722.15 feet to a point for a corner hereof;

THENCE North 45°23'58" East a distance of 1170.26 feet to a point for a corner hereof;



THENCE South 46°36'24" East a distance of 2204.70 feet to a point for a corner hereof;

THENCE South 44°00'06" West a distance of 682.39 feet to a point for a corner hereof;

THENCE South 26°00'55" East a distance of 223.48 feet to a point in the north line of Farm to Market Road No. 719 for a corner hereof;

THENCE along the north lines of Farm to Market Road No. 719, the following 3 courses:

1. North 84°02'07" East a distance of 150.62 feet to a point for a corner hereof;
2. North 78°14'54" East a distance of 505.89 feet to a point for a corner hereof;
3. North 78°18'16" East a distance of 1888.85 feet to a point in the west line of Farm to Market Road No. 792 for a corner hereof;

THENCE along the west lines of Farm to Market Road No. 792, the following 8 courses:

1. North 13°41'20" West a distance of 508.02 feet to a point for a corner hereof;
2. North 10°51'43" West a distance of 190.81 feet to a point for a corner hereof;
3. North 03°18'38" West a distance of 55.56 feet to a point for a corner hereof;
4. North 03°18'38" West a distance of 159.16 feet to a point for a corner hereof;
5. North 03°06'58" East a distance of 718.34 feet to a point for a corner hereof;
6. North 03°52'41" East a distance of 202.41 feet to a point for a corner hereof;
7. North 03°52'34" East a distance of 558.56 feet to a point for a corner hereof;
8. North 03°01'31" East a distance of 267.75 feet to a point for a corner hereof;

THENCE South 86°15'19" East a distance of 120.72 feet over and across Farm to Market Road No. 792 to a point in the east line of Farm to Market Road No. 792 for a corner hereof;

THENCE along the east lines of Farm to Market Road No. 792, the following 8 courses:

1. South 03°44'41" West a distance of 717.02 feet to a point for a corner hereof;
2. South 00°19'46" East a distance of 152.88 feet to a point for a corner hereof;
3. South 03°38'49" West a distance of 743.52 feet to a point for a corner hereof;
4. South 03°46'50" East a distance of 338.86 feet to a point for a corner hereof;
5. South 07°58'58" East a distance of 103.17 feet to a point for a corner hereof;
6. South 10°19'55" East a distance of 104.67 feet to a point for a corner hereof;
7. South 10°59'09" East a distance of 464.29 feet to a point for a corner hereof;
8. South 10°59'09" East a distance of 517.67 feet to a point for a corner hereof;

THENCE North 77°26'02" East a distance of 431.00 feet to a point for a corner hereof;

THENCE South 13°29'09" East a distance of 286.67 feet to a point for a corner hereof;

THENCE North 75°37'07" East a distance of 269.84 feet to a point for a corner hereof;

THENCE South 11°58'40" East a distance of 120.19 feet to a point for a corner hereof;

THENCE South 78°04'06" East a distance of 682.63 feet to a point for a corner hereof;

THENCE South 07°20'10" East a distance of 1854.46 feet to a point for a corner hereof;

THENCE South 06°36'03" East a distance of 1096.84 feet to a point for a corner hereof;

THENCE North 81°39'44" East a distance of 1354.76 feet to a point for a corner hereof;

THENCE North 75°27'51" East a distance of 325.95 feet to a point for a corner hereof;

THENCE South 07°42'56" East a distance of 1165.93 feet to a point for a corner hereof;

THENCE South 86°19'53" West a distance of 252.95 feet to a point in the northeast line of State Highway No. 72 for a corner hereof;

THENCE along the north lines of State Highway No. 72, the following 11 courses:

1. South 59°46'33" East a distance of 279.88 feet to a point for a corner hereof;
2. South 59°46'33" East a distance of 89.32 feet to a point for a corner hereof;
3. South 62°48'01" East a distance of 503.83 feet to a point for a corner hereof;
4. South 72°46'05" East a distance of 195.58 feet to a point for a corner hereof;
5. South 82°44'02" East a distance of 305.19 feet to a point for a corner hereof;
6. North 80°31'41" East a distance of 119.01 feet to a point for a corner hereof;
7. North 79°31'14" East a distance of 202.44 feet to a point for a corner hereof;
8. North 74°02'36" East a distance of 521.62 feet to a point for a corner hereof;
9. North 74°13'24" East a distance of 432.81 feet to a point for a corner hereof;
10. North 74°13'27" East a distance of 136.08 feet to a point for a corner hereof;
11. North 74°19'28" East a distance of 29.79 feet to a point for a corner hereof;

THENCE South 15°37'25" East a distance of 110.23 feet over and across State Highway No. 72 to a point in the south line of State Highway No. 72 for a corner hereof;

THENCE along the south lines of State Highway No. 72, the following 6 courses:

1. South 74°22'35" West a distance of 134.52 feet to a point for a corner hereof;
2. South 74°22'35" West a distance of 161.48 feet to a point for a corner hereof;
3. South 74°22'36" West a distance of 550.05 feet to a point for a corner hereof;
4. South 73°26'24" West a distance of 267.56 feet to a point for a corner hereof;
5. South 81°36'38" West a distance of 227.68 feet to a point for a corner hereof;
6. South 87°38'33" West a distance of 137.05 feet to a point in the south line of Business State Highway No. 72 for a corner hereof;

THENCE along the south lines of Business State Highway No. 72, the following 5 courses:

1. South 88°54'53" West a distance of 867.64 feet to a point for a corner hereof;
2. South 89°28'29" West a distance of 83.54 feet to a point for a corner hereof;
3. South 89°28'29" West a distance of 122.11 feet to a point for a corner hereof;
4. South 89°28'29" West a distance of 195.41 feet to a point for a corner hereof;
5. South 89°14'25" West a distance of 204.60 feet to a point for a corner hereof;

THENCE South 04°55'05" East a distance of 2328.52 feet to a point in the north line of Dewitt Street for a corner hereof;

THENCE South 88°29'32" East a distance of 167.89 feet along the north line of Dewitt Street to a point for a corner hereof;

THENCE North 02°43'11" West a distance of 457.01 feet to a point for a corner hereof;

THENCE North 87°23'59" East a distance of 474.37 feet to a point in the west line of County Road No. 329 for a corner hereof;

THENCE along the west lines of County Road No. 329, the following 2 courses:

1. South 06°34'28" East a distance of 280.27 feet to a point for a corner hereof;
2. South 03°33'23" West a distance of 232.90 feet to a point for a corner hereof;

THENCE over and across County Road No. 329, the following 2 courses:

1. South 60°16'19" East a distance of 48.83 feet to a point for a corner hereof;
2. South 43°52'15" East a distance of 608.42 feet to a point for a corner hereof;

THENCE South 85°18'34" West a distance of 123.48 feet to a point for a corner hereof;

THENCE South 02°59'31" East a distance of 302.17 feet to a point for a corner hereof;

THENCE North 89°26'58" West a distance of 808.25 feet to a point for a corner hereof;

THENCE North 02°17'39" West a distance of 700.48 feet to a point in the south line of Dewitt Street for a corner hereof;

THENCE South 88°25'03" West a distance of 1005.93 feet along the south line of Dewitt Street to a point for a corner hereof;

THENCE South 81°09'52" West a distance of 196.74 feet over and across Farm to Market Road No. 743 to a point in the west line of Farm to Market Road No. 743 for a corner hereof;

THENCE along the west lines of Farm to Market Road No. 743, the following 2 courses:

1. South 08°30'58" East a distance of 413.64 feet to a point for a corner hereof;
2. South 06°11'02" East a distance of 1185.79 feet to a point for a corner hereof;

THENCE South 85°05'42" West a distance of 672.17 feet to a point for a corner hereof;

THENCE South 07°19'50" East a distance of 190.39 feet to a point for a corner hereof;

THENCE South 82°53'22" West a distance of 583.24 feet to a point for a corner hereof;

THENCE South 47°15'55" East a distance of 187.66 feet to a point for a corner hereof;

THENCE South 34°59'14" East a distance of 299.04 feet to a point for a corner hereof;

THENCE South 29°51'39" East a distance of 231.78 feet to a point for a corner hereof;

THENCE South 25°33'49" East a distance of 246.81 feet to a point for a corner hereof;

THENCE South 18°16'27" East a distance of 202.00 feet to a point for a corner hereof;

THENCE South 10°06'36" East a distance of 375.85 feet to a point for a corner hereof;

THENCE South 84°21'42" West a distance of 362.78 feet to a point for a corner hereof;

THENCE South 13°18'39" East a distance of 344.63 feet to a point for a corner hereof;

THENCE South 75°31'14" West a distance of 184.78 feet to a point in the east line of Cottonwood Street for a corner hereof;

THENCE South 12°26'36" East a distance of 503.81 feet along the east line of Cottonwood Street to a point for a corner hereof;

THENCE South 77°15'07" West a distance of 491.16 feet to a point for a corner hereof;

THENCE North 06°34'28" West a distance of 350.34 feet to a point for a corner hereof;

THENCE North 80°14'43" East a distance of 194.33 feet to a point for a corner hereof;

THENCE North 11°10'53" West a distance of 1389.13 feet to a point for a corner hereof;

THENCE North 89°26'59" West a distance of 1177.60 feet to a point for a corner hereof;

THENCE South 04°46'22" East a distance of 2034.63 feet to a point for a corner hereof;

THENCE South 78°40'00" West a distance of 1506.90 feet to a point in the east line of Business U. S. Highway No. 181 for a corner hereof;

THENCE along the east line of Business U. S. Highway No. 181, the following courses:

1. South 21°32'15" East a distance of 116.48 feet to a point for a corner hereof;
2. Following a curve turning to the right through 29°00'26", having a radius of 1802.83 feet, and whose long chord bears South 07°02'02" East a distance of 903.00 feet to a point for a corner hereof;
3. Following a curve turning to the right through an angle of 12°17'51", having a radius of 1802.83 feet, and whose long chord bears South 13°37'13" West a distance of 386.20 feet to a point for a corner hereof;
4. South 19°45'45" West a distance of 954.26 feet to a point for a corner hereof;

THENCE South 46°41'19" East a distance of 2779.58 feet to a point for a corner hereof;

THENCE South 46°41'19" East a distance of 2640.00 feet to a point for a corner hereof;

THENCE South 43°37'03" West a distance of 2460.91 feet to a point for a corner hereof;

THENCE North 47°06'39" West a distance of 2638.10 feet to the POINT OF BEGINNING containing 2574.64 acres more or less, and as shown on certified plat herewith.

**SECTION A - 7.80 ACRES**

**SECTION B - 7.52 ACRES**

**SECTION C - 6.45 ACRES**

**SECTION D - 7.56 ACRES**

**SECTION E - 12.59 ACRES**

**SECTION F - 14.77 ACES**

**SECTION G - 4.28 ACRES**

**SECTION H - 7.47 ACRES**

**LESS AND EXCEPT**

Tract 1 - approximately 44.30 acres more or less as shown on plat herewith.

Tract 2 - approximately 10.81 acres more or less as shown on plat herewith.

Tract 3 - approximately 129.16 acres more or less as shown on plat herewith.

Note: Bearings, distances and acreage shown hereon are NAD 83, South Central Zone and are derived from GPS techniques. Iron Rods set are a 1/2 inch rod with plastic caps marked "INTREPID".

Surveyed by;

March 10, 2020

Sherman L. Posey, R.P.L.S.  
Job# 20-1080.



**EXISTING EXTRATERRITORIAL JURISDICTION - 2390.37 ACRES**

**LEGAL DESCRIPTION:** Being 2574.64 acres of land for the purpose of delineating a Defined Territory for the Existing Extraterritorial Jurisdiction Limit in Kenedy, Karnes County, Texas:

**BEGINNING** at a 5/8 inch iron rod found for the south corner of that certain PID# 70504 and a southwest corner hereof;

THENCE North 46°32'40" West a distance of 1109.31 feet to a point in the east line of U. S. Highway No. 181 for an interior corner hereof;

THENCE along the east lines of U. S. Highway No. 181, the following 14 courses:

1. South 07°16'22" East a distance of 1025.72 feet to a point for a corner hereof;
2. South 08°30'05" East a distance of 409.36 feet to a point for a corner hereof;
3. South 06°44'51" East a distance of 1150.24 feet to a point for a corner hereof;
4. South 07°16'54" East a distance of 34.59 feet to a point for a corner hereof;
5. South 06°03'11" East a distance of 78.08 feet to a point for a corner hereof;
6. South 04°46'17" East a distance of 213.12 feet to a point for a corner hereof;
7. South 03°31'35" East a distance of 480.72 feet to a point for a corner hereof;
8. South 47°49'25" East a distance of 70.78 feet to a point for a corner hereof;
9. South 17°03'54" West a distance of 88.19 feet to a point for a corner hereof;
10. South 73°34'13" West a distance of 100.05 feet to a point for a corner hereof;
11. South 23°59'36" West a distance of 41.35 feet to a point for a corner hereof;
12. South 03°26'22" East a distance of 410.84 feet to a point for a corner hereof;
13. South 30°35'16" East a distance of 168.50 feet to a point for a corner hereof;
14. South 02°52'00" East a distance of 85.22 feet to a point for a corner hereof;

THENCE South 87°08'00" West a distance of 192.64 feet over and across U. S. Highway No. 181 to a point in the west line of U. S. Highway No. 181, for a corner hereof;

THENCE along the west lines of U. S. Highway No. 181, the following 13 courses:

1. North 02°12'13" West a distance of 175.48 feet to a point for a corner hereof;
2. North 00°32'03" West a distance of 319.25 feet to a point for a corner hereof;
3. North 02°36'17" West a distance of 891.51 feet to a point for a corner hereof;
4. North 05°54'18" West a distance of 101.76 feet to a point for a corner hereof;
5. North 05°54'20" West a distance of 533.68 feet to a point for a corner hereof;
6. North 07°05'08" West a distance of 620.50 feet to a point for a corner hereof;
7. North 22°34'17" West a distance of 26.92 feet to a point for a corner hereof;
8. North 07°57'48" West a distance of 1436.39 feet to a point for a corner hereof;
9. North 07°36'02" West a distance of 373.06 feet to a point for a corner hereof;
10. North 05°19'32" West a distance of 539.10 feet to a point for a corner hereof;
11. North 06°38'42" West a distance of 653.18 feet to a point for a corner hereof;
12. North 05°49'03" West a distance of 484.75 feet to a point for a corner hereof;
13. North 03°38'58" West a distance of 48.69 feet to a point in the south line of Farm to Market Road No. 2509 for a corner hereof;

THENCE along the east lines of Farm to Market Road No. 2509, the following 10 courses:

1. South 61°42'15" West a distance of 383.14 feet to a point for a corner hereof;
2. South 55°18'49" West a distance of 137.62 feet to a point for a corner hereof;
3. South 48°48'16" West a distance of 109.55 feet to a point for a corner hereof;
4. South 45°38'17" West a distance of 214.25 feet to a point for a corner hereof;

P.O. Box 519 ♦ 1004 C Street

Floreola, TX 78114  
C. (830) 393-8833

F. (830) 393-3388

5. South 40°41'16" West a distance of 232.09 feet to a point for a corner hereof;
6. South 31°04'09" West a distance of 73.20 feet to a point for a corner hereof;
7. South 29°23'59" West a distance of 713.11 feet to a point for a corner hereof;
8. South 24°47'56" West a distance of 481.21 feet to a point for a corner hereof;
9. South 13°18'34" West a distance of 339.17 feet to a point for a corner hereof;
10. South 08°56'09" West a distance of 54.84 feet to a point for a corner hereof;

THENCE North 81°33'55" West a distance of 254.67 feet over and across Farm to Market Road No. 2509 to a point in the west line of Farm to Market Road No. 2509 for a corner hereof;

THENCE along the west lines of Farm to Market Road No. 2509, the following 10 courses:

1. North 08°26'05" East a distance of 89.25 feet to a point for a corner hereof;
2. North 16°13'47" East a distance of 184.26 feet to a point for a corner hereof;
3. North 19°37'17" East a distance of 286.31 feet to a point for a corner hereof;
4. North 27°36'37" East a distance of 479.79 feet to a point for a corner hereof;
5. North 33°19'26" East a distance of 306.32 feet to a point for a corner hereof;
6. North 19°25'49" East a distance of 30.97 feet to a point for a corner hereof;
7. North 08°45'50" East a distance of 42.60 feet to a point for a corner hereof;
8. North 35°57'26" East a distance of 430.94 feet to a point for a corner hereof;
9. North 42°44'24" East a distance of 450.98 feet to a point for a corner hereof;
10. North 59°54'26" East a distance of 568.75 feet to a point in the west line of U. S. Highway No. 181, for a corner hereof;

THENCE along the west lines of U. S. Highway No. 181, the following 11 courses:

1. North 27°27'31" East a distance of 131.67 feet to a point for a corner hereof;
2. North 00°33'40" West a distance of 437.60 feet to a point for a corner hereof;
3. North 08°19'48" West a distance of 889.65 feet to a point for a corner hereof;
4. North 07°36'36" West a distance of 573.56 feet to a point for a corner hereof;
5. North 06°36'22" West a distance of 485.21 feet to point for a corner hereof;
6. North 07°21'54" West a distance of 1563.51 feet to a point for a corner hereof;
7. South 82°57'40" West a distance of 33.62 feet to a point for a corner hereof;
8. North 07°23'56" West a distance of 780.00 feet to a point for a corner hereof;
9. North 07°30'21" West a distance of 688.60 feet to a point for a corner hereof;
10. North 08°15'38" West a distance of 722.12 feet to a point for a corner hereof;
11. North 46°04'41" West a distance of 163.24 feet to a point in the south line of Farm to Market Road No. 1145 for an interior corner hereof;

THENCE South 89°29'54" West a distance of 2688.26 feet along the south line of Farm to Market Road No. 1145 to a point for a corner hereof;

THENCE North 00°33'18" West a distance of 159.98 feet over and across Farm to Market Road No. 1145 to a point in the north line of Farm to Market Road No. 1145 for a corner hereof;

THENCE North 89°50'42" East a distance of 2665.02 feet along the north line of Farm to Market Road No. 1145 to a point in the west line of U. S. Highway No. 181 for a corner hereof;

THENCE along the west lines of U. S. Highway No. 181, the following 2 courses:

1. North 30°28'54" East a distance of 165.47 feet to a point for a corner hereof;
2. North 06°57'12" West a distance of 898.50 feet to a point for a corner hereof;

THENCE South 88°42'10" West a distance of 134.78 feet to a point for a corner hereof;

THENCE North 45°29'30" West a distance of 676.10 feet to a point for a corner hereof;  
THENCE North 76°30'49" East a distance of 215.00 feet to a point for a corner hereof;  
THENCE North 05°40'15" West a distance of 158.58 feet to a point for a corner hereof;  
THENCE North 81°37'20" East a distance of 328.93 feet to a point for a corner hereof;  
THENCE North 11°04'59" West a distance of 43.22 feet to a point for a corner hereof;  
THENCE North 46°53'05" West a distance of 559.53 feet to a point for a corner hereof;  
THENCE North 85°13'01" East a distance of 93.78 feet to a point for a corner hereof;  
THENCE North 03°47'52" West a distance of 213.51 feet to a point for a corner hereof;  
THENCE North 86°57'38" West a distance of 28.66 feet to a point for a corner hereof;  
THENCE North 02°58'17" West a distance of 486.47 feet to a point for a corner hereof;  
THENCE North 45°46'30" West a distance of 304.68 feet to a point in the southeast line of  
State Highway No. 72 for a corner hereof;  
THENCE South 43°38'34" West a distance of 1640.12 feet along the southeast line of State  
Highway No. 72 to a point for a corner hereof;  
THENCE South 35°00'45" East a distance of 338.23 feet to a point for a corner hereof;  
THENCE South 45°33'56" West a distance of 179.15 feet to a point for a corner hereof;  
THENCE South 02°55'09" East a distance of 73.17 feet to a point for a corner hereof;  
THENCE South 51°15'40" West a distance of 62.92 feet to a point for a corner hereof;  
THENCE North 58°13'53" West a distance of 85.41 feet to a point for a corner hereof;  
THENCE South 49°51'13" West a distance of 145.96 feet to a point for a corner hereof;  
THENCE North 36°29'58" West a distance of 282.87 feet to a point in the southeast line of  
State Highway No. 72 to a point for a corner hereof;

THENCE along the southeast lines of State Highway No. 72, the following 10 courses:

1. South 42°41'13" West a distance of 125.36 feet to a point for a corner hereof;
2. South 16°58'48" West a distance of 20.41 feet to a point for a corner hereof;
3. South 41°39'24" West a distance of 694.12 feet to a point for a corner hereof;
4. South 44°06'42" West a distance of 30.66 feet to a point for a corner hereof;
5. South 44°06'41" West a distance of 523.24 feet to a point for a corner hereof;
6. South 43°30'43" West a distance of 517.57 feet to a point for a corner hereof;
7. South 45°29'20" West a distance of 279.35 feet to a point for a corner hereof;
8. South 56°36'26" West a distance of 202.47 feet to a point for a corner hereof;
9. South 44°02'12" West a distance of 219.31 feet to a point for a corner hereof;
10. South 41°47'36" West a distance of 200.63 feet to a point for a corner hereof;

THENCE North 48°12'24" West a distance of 109.22 feet over and across State Highway No.  
72 to a point in the northwest line of State Highway No. 72 for a corner hereof;

THENCE along the northwest lines of State Highway No. 72, the following 4 courses:



1. North 44°26'24" East a distance of 87.31 feet to a point for a corner hereof;
2. North 43°55'53" East a distance of 919.57 feet to a point for a corner hereof;
3. North 44°06'21" East a distance of 864.86 feet to a point for a corner hereof;
4. North 44°29'36" East a distance of 768.28 feet to a point for a corner hereof;

THENCE North 68°53'40" West a distance of 321.79 feet to a point for a corner hereof;

THENCE North 28°45'12" East a distance of 796.15 feet over and across Farm to Market Road No. 2102 to a point in the northeast line of Farm to Market Road No. 2102 for a corner hereof;

THENCE North 70°45'05" West a distance of 911.31 feet along the northeast line of Farm to Market Road No. 2102 to a point for a corner hereof;

THENCE North 27°11'14" East a distance of 978.95 feet to a point for a corner hereof;

THENCE South 52°17'35" East a distance of 26.94 feet to a point for a corner hereof;

THENCE North 26°57'59" East a distance of 2247.44 feet to a point for a corner hereof;

THENCE South 88°22'09" East a distance of 146.66 feet to a point for a corner hereof;

THENCE South 83°58'22" East a distance of 202.89 feet to a point for a corner hereof;

THENCE South 10°32'25" East a distance of 848.62 feet to a point for a corner hereof;

THENCE North 82°01'07" West a distance of 192.52 feet to a point for a corner hereof;

THENCE South 47°03'27" West a distance of 148.73 feet to a point for a corner hereof;

THENCE South 02°35'13" East a distance of 202.27 feet to a point in the northeast line of Bellaire Boulevard for a corner hereof;

THENCE along the northeast lines of Bellaire Boulevard, the following 3 courses:

THENCE South 07°07'01" East a distance of 145.17 feet to a point for a corner hereof;

THENCE South 41°21'23" East a distance of 144.98 feet to a point for a corner hereof;

THENCE South 48°40'42" East a distance of 504.15 feet to a point for a corner hereof;

THENCE North 50°29'46" East a distance of 408.44 feet to a point for a corner hereof;

THENCE North 00°41'06" East a distance of 1520.07 feet over and across U. S. Highway No. 181 to a point for a corner hereof;

THENCE North 68°42'43" East a distance of 30.81 feet over and across U. S. Highway No. 181 to a point for a corner hereof;

THENCE North 54°04'38" East a distance of 31.41 feet over and across U. S. Highway No. 181 to a point for a corner hereof;

THENCE North 41°18'19" East a distance of 278.28 feet to a point for a corner hereof;

THENCE North 47°37'40" East a distance of 665.79 feet to a point for a corner hereof;

THENCE North 45°54'14" West a distance of 1277.56 feet over and across U. S. Highway No. 181 to a point for a corner hereof;

THENCE South 11°23'02" West a distance of 513.01 feet over and across U. S. Highway No. 181 to a point for a corner hereof;

THENCE South 39°54'12" West a distance of 606.90 feet to a point for a corner hereof;  
THENCE South 15°17'40" East a distance of 73.23 feet to a point for a corner hereof;  
THENCE North 68°32'31" West a distance of 90.65 feet to a point for a corner hereof;  
THENCE South 73°29'52" West a distance of 29.11 feet to a point for a corner hereof;  
THENCE South 50°29'40" West a distance of 66.86 feet to a point for a corner hereof;  
THENCE South 32°32'37" West a distance of 109.84 feet to a point for a corner hereof;  
THENCE South 42°16'40" West a distance of 76.42 feet to a point for a corner hereof;  
THENCE South 28°01'57" West a distance of 50.14 feet to a point for a corner hereof;  
THENCE South 33°40'42" West a distance of 53.27 feet to a point for a corner hereof;  
THENCE South 19°20'09" West a distance of 70.06 feet to a point for a corner hereof;  
THENCE South 19°20'09" West a distance of 76.74 feet to a point for a corner hereof;  
THENCE South 39°14'05" West a distance of 109.37 feet to a point for a corner hereof;  
THENCE South 52°16'19" West a distance of 82.81 feet to a point for a corner hereof;  
THENCE South 71°32'24" West a distance of 130.34 feet to a point for a corner hereof;  
THENCE South 74°55'26" West a distance of 55.79 feet to a point for a corner hereof;  
THENCE South 78°19'11" West a distance of 93.72 feet to a point for a corner hereof;  
THENCE South 87°08'23" West a distance of 100.11 feet to a point for a corner hereof;  
THENCE North 85°10'29" West a distance of 106.50 feet to a point for a corner hereof;  
THENCE North 81°59'37" West a distance of 66.73 feet to a point for a corner hereof;  
THENCE North 70°00'51" West a distance of 102.58 feet to a point for a corner hereof;  
THENCE North 60°19'10" West a distance of 83.37 feet to a point for a corner hereof;  
THENCE North 50°28'32" West a distance of 49.66 feet to a point for a corner hereof;  
THENCE North 48°28'04" West a distance of 56.67 feet to a point for a corner hereof;  
THENCE North 31°01'09" West a distance of 39.45 feet to a point for a corner hereof;  
THENCE North 44°21'44" West a distance of 133.01 feet to a point for a corner hereof;  
THENCE North 64°17'10" West a distance of 8.92 feet to a point for a corner hereof;  
THENCE North 40°39'32" West a distance of 95.05 feet to a point for a corner hereof;  
THENCE North 47°48'20" West a distance of 73.09 feet to a point for a corner hereof;  
THENCE North 05°01'36" West a distance of 108.92 feet to a point for a corner hereof;

THENCE North 11°48'50" West a distance of 2863.52 feet to a point for a corner hereof;

THENCE North 42°44'03" East a distance of 840.80 feet to a point for a corner hereof;

THENCE North 43°11'53" West a distance of 503.99 feet to a point for a corner hereof;

THENCE North 45°10'56" East a distance of 408.05 feet to a point in the southwest line of U. S. Highway No. 181 for a corner hereof;

THENCE along the southwest lines of U. S. Highway No. 181, the following 9 courses:

1. North 45°44'20" West a distance of 123.80 feet to a point for a corner hereof;
2. North 45°16'15" West a distance of 288.28 feet to a point for a corner hereof;
3. North 44°00'56" West a distance of 282.64 feet to a point for a corner hereof;
4. North 45°30'57" West a distance of 289.42 feet to a point for a corner hereof;
5. North 45°01'25" West a distance of 287.14 feet to a point for a corner hereof;
6. North 43°53'40" West a distance of 229.14 feet to a point for a corner hereof;
7. North 26°06'33" West a distance of 383.98 feet to a point for a corner hereof;
8. North 23°39'07" West a distance of 428.70 feet to a point for a corner hereof;
9. North 23°23'35" West a distance of 369.44 feet to a point for a corner hereof;

THENCE North 66°09'11" East a distance of 141.86 feet over and across U. S. Highway No. 181 to a point in the northeast line of U. S. Highway No. 181 for a corner hereof;

THENCE along the northeast lines of U. S. Highway No. 181, the following 16 courses:

1. South 23°50'49" East a distance of 249.46 feet to a point for a corner hereof;
2. South 23°50'49" East a distance of 480.03 feet to a point for a corner hereof;
3. South 23°50'49" East a distance of 108.52 feet to a point for a corner hereof;
4. South 24°10'19" East a distance of 88.35 feet to a point for a corner hereof;
5. South 34°25'36" East a distance of 59.95 feet to a point for a corner hereof;
6. South 34°25'36" East a distance of 260.03 feet to a point for a corner hereof;
7. South 34°58'34" East a distance of 211.47 feet to a point for a corner hereof;
8. South 45°42'08" East a distance of 174.43 feet to a point for a corner hereof;
9. South 50°14'43" East a distance of 89.60 feet to a point for a corner hereof;
10. South 45°59'04" East a distance of 148.11 feet to a point for a corner hereof;
11. South 45°59'04" East a distance of 176.09 feet to a point for a corner hereof;
12. South 46°14'03" East a distance of 83.25 feet to a point for a corner hereof;
13. South 46°17'19" East a distance of 306.87 feet to a point for a corner hereof;
14. South 46°17'19" East a distance of 407.74 feet to a point for a corner hereof;
15. South 46°17'19" East a distance of 28.92 feet to a point for a corner hereof;
16. South 44°41'11" East a distance of 43.92 feet to a point for a corner hereof;

THENCE North 48°23'50" East a distance of 469.25 feet to a point for a corner hereof;

THENCE South 47°37'21" East a distance of 99.84 feet to a point for a corner hereof;

THENCE South 44°54'34" West a distance of 492.89 feet to a point in the northeast line of U. S. Highway No. 181 for a corner hereof;

THENCE South 41°09'40" East a distance of 119.97 feet along the northeast line of U. S. Highway No. 181 to a point for a corner hereof;

THENCE North 43°30'15" East a distance of 1234.31 feet to a point for a corner hereof;

THENCE South 47°04'21" East a distance of 722.15 feet to a point for a corner hereof;

THENCE North 45°23'58" East a distance of 1170.26 feet to a point for a corner hereof;

THENCE South 46°36'24" East a distance of 2204.70 feet to a point for a corner hereof;

THENCE South 44°00'06" West a distance of 682.39 feet to a point for a corner hereof;

THENCE South 26°00'55" East a distance of 223.48 feet to a point in the north line of Farm to Market Road No. 719 for a corner hereof;

THENCE along the north lines of Farm to Market Road No. 719, the following 3 courses:

1. North 84°02'07" East a distance of 150.62 feet to a point for a corner hereof;
2. North 78°14'54" East a distance of 505.89 feet to a point for a corner hereof;
3. North 78°18'16" East a distance of 1888.85 feet to a point in the west line of Farm to Market Road No. 792 for a corner hereof;

THENCE along the west lines of Farm to Market Road No. 792, the following 8 courses:

1. North 13°41'20" West a distance of 508.02 feet to a point for a corner hereof;
2. North 10°51'43" West a distance of 190.81 feet to a point for a corner hereof;
3. North 03°18'38" West a distance of 55.56 feet to a point for a corner hereof;
4. North 03°18'38" West a distance of 159.16 feet to a point for a corner hereof;
5. North 03°06'58" East a distance of 718.34 feet to a point for a corner hereof;
6. North 03°52'41" East a distance of 202.41 feet to a point for a corner hereof;
7. North 03°52'34" East a distance of 558.56 feet to a point for a corner hereof;
8. North 03°01'31" East a distance of 267.75 feet to a point for a corner hereof;

THENCE South 86°15'19" East a distance of 120.72 feet over and across Farm to Market Road No. 792 to a point in the east line of Farm to Market Road No. 792 for a corner hereof;

THENCE along the east lines of Farm to Market Road No. 792, the following 8 courses:

1. South 03°44'41" West a distance of 717.02 feet to a point for a corner hereof;
2. South 00°19'46" East a distance of 152.88 feet to a point for a corner hereof;
3. South 03°38'49" West a distance of 743.52 feet to a point for a corner hereof;
4. South 03°46'50" East a distance of 338.86 feet to a point for a corner hereof;
5. South 07°58'58" East a distance of 103.17 feet to a point for a corner hereof;
6. South 10°19'55" East a distance of 104.67 feet to a point for a corner hereof;
7. South 10°59'09" East a distance of 464.29 feet to a point for a corner hereof;
8. South 10°59'09" East a distance of 517.67 feet to a point for a corner hereof;

THENCE North 77°26'02" East a distance of 431.00 feet to a point for a corner hereof;

THENCE South 13°29'09" East a distance of 286.67 feet to a point for a corner hereof;

THENCE North 75°37'07" East a distance of 269.84 feet to a point for a corner hereof;

THENCE South 11°58'40" East a distance of 120.19 feet to a point for a corner hereof;

THENCE South 78°04'06" East a distance of 682.63 feet to a point for a corner hereof;

THENCE South 07°20'10" East a distance of 1854.46 feet to a point for a corner hereof;

THENCE South 06°36'03" East a distance of 1096.84 feet to a point for a corner hereof;

THENCE North 81°39'44" East a distance of 1354.76 feet to a point for a corner hereof;

THENCE North 75°27'51" East a distance of 325.95 feet to a point for a corner hereof;

THENCE South 07°42'56" East a distance of 1165.93 feet to a point for a corner hereof;

THENCE South 86°19'53" West a distance of 252.95 feet to a point in the northeast line of State Highway No. 72 for a corner hereof;

THENCE along the north lines of State Highway No. 72, the following 11 courses:

1. South 59°46'33" East a distance of 279.88 feet to a point for a corner hereof;
2. South 59°46'33" East a distance of 89.32 feet to a point for a corner hereof;
3. South 62°48'01" East a distance of 503.83 feet to a point for a corner hereof;
4. South 72°46'05" East a distance of 195.58 feet to a point for a corner hereof;
5. South 82°44'02" East a distance of 305.19 feet to a point for a corner hereof;
6. North 80°31'41" East a distance of 119.01 feet to a point for a corner hereof;
7. North 79°31'14" East a distance of 202.44 feet to a point for a corner hereof;
8. North 74°02'36" East a distance of 521.62 feet to a point for a corner hereof;
9. North 74°13'24" East a distance of 432.81 feet to a point for a corner hereof;
10. North 74°13'27" East a distance of 136.08 feet to a point for a corner hereof;
11. North 74°19'28" East a distance of 29.79 feet to a point for a corner hereof;

THENCE South 15°37'25" East a distance of 110.23 feet over and across State Highway No. 72 to a point in the south line of State Highway No. 72 for a corner hereof;

THENCE along the south lines of State Highway No. 72, the following 6 courses:

1. South 74°22'35" West a distance of 134.52 feet to a point for a corner hereof;
2. South 74°22'35" West a distance of 161.48 feet to a point for a corner hereof;
3. South 74°22'36" West a distance of 550.05 feet to a point for a corner hereof;
4. South 73°26'24" West a distance of 267.56 feet to a point for a corner hereof;
5. South 81°36'38" West a distance of 227.68 feet to a point for a corner hereof;
6. South 87°38'33" West a distance of 137.05 feet to a point in the south line of Business State Highway No. 72 for a corner hereof;

THENCE along the south lines of Business State Highway No. 72, the following 5 courses:

1. South 88°54'53" West a distance of 867.64 feet to a point for a corner hereof;
2. South 89°28'29" West a distance of 83.54 feet to a point for a corner hereof;
3. South 89°28'29" West a distance of 122.11 feet to a point for a corner hereof;
4. South 89°28'29" West a distance of 195.41 feet to a point for a corner hereof;
5. South 89°14'25" West a distance of 204.60 feet to a point for a corner hereof;

THENCE South 04°55'05" East a distance of 2328.52 feet to a point in the north line of Dewitt Street for a corner hereof;

THENCE South 88°29'32" East a distance of 167.89 feet along the north line of Dewitt Street to a point for a corner hereof;

THENCE North 02°43'11" West a distance of 457.01 feet to a point for a corner hereof;

THENCE North 87°23'59" East a distance of 474.37 feet to a point in the west line of County Road No. 329 for a corner hereof;

THENCE along the west lines of County Road No. 329, the following 2 courses:

1. South 06°34'28" East a distance of 280.27 feet to a point for a corner hereof;
2. South 03°33'23" West a distance of 232.90 feet to a point for a corner hereof;

THENCE over and across County Road No. 329, the following 2 courses:

1. South 60°16'19" East a distance of 48.83 feet to a point for a corner hereof;
2. South 43°52'15" East a distance of 608.42 feet to a point for a corner hereof;

THENCE South 85°18'34" West a distance of 123.48 feet to a point for a corner hereof;

THENCE South 02°59'31" East a distance of 302.17 feet to a point for a corner hereof;

THENCE North 89°26'58" West a distance of 808.25 feet to a point for a corner hereof;

THENCE North 02°17'39" West a distance of 700.48 feet to a point in the south line of Dewitt Street for a corner hereof;

THENCE South 88°25'03" West a distance of 1005.93 feet along the south line of Dewitt Street to a point for a corner hereof;

THENCE South 81°09'52" West a distance of 196.74 feet over and across Farm to Market Road No. 743 to a point in the west line of Farm to Market Road No. 743 for a corner hereof;

THENCE along the west lines of Farm to Market Road No. 743, the following 2 courses:

1. South 08°30'58" East a distance of 413.64 feet to a point for a corner hereof;
2. South 06°11'02" East a distance of 1185.79 feet to a point for a corner hereof;

THENCE South 85°05'42" West a distance of 672.17 feet to a point for a corner hereof;

THENCE South 07°19'50" East a distance of 190.39 feet to a point for a corner hereof;

THENCE South 82°53'22" West a distance of 583.24 feet to a point for a corner hereof;

THENCE South 47°15'55" East a distance of 187.66 feet to a point for a corner hereof;

THENCE South 34°59'14" East a distance of 299.04 feet to a point for a corner hereof;

THENCE South 29°51'39" East a distance of 231.78 feet to a point for a corner hereof;

THENCE South 25°33'49" East a distance of 246.81 feet to a point for a corner hereof;

THENCE South 18°16'27" East a distance of 202.00 feet to a point for a corner hereof;

THENCE South 10°06'36" East a distance of 375.85 feet to a point for a corner hereof;

THENCE South 84°21'42" West a distance of 362.78 feet to a point for a corner hereof;

THENCE South 13°18'39" East a distance of 344.63 feet to a point for a corner hereof;

THENCE South 75°31'14" West a distance of 184.78 feet to a point in the east line of Cottonwood Street for a corner hereof;

THENCE South 12°26'36" East a distance of 503.81 feet along the east line of Cottonwood Street to a point for a corner hereof;

THENCE South 77°15'07" West a distance of 491.16 feet to a point for a corner hereof;

THENCE North 06°34'28" West a distance of 350.34 feet to a point for a corner hereof;

THENCE North 80°14'43" East a distance of 194.33 feet to a point for a corner hereof;

THENCE North 11°10'53" West a distance of 1389.13 feet to a point for a corner hereof;

THENCE North 89°26'59" West a distance of 1177.60 feet to a point for a corner hereof;

THENCE South 04°46'22" East a distance of 2034.63 feet to a point for a corner hereof;

THENCE South 78°40'00" West a distance of 1506.90 feet to a point in the east line of Business U. S. Highway No. 181 for a corner hereof;

THENCE along the east line of Business U. S. Highway No. 181, the following courses:

1. South 21°32'15" East a distance of 116.48 feet to a point for a corner hereof;
2. Following a curve turning to the right through 29°00'26", having a radius of 1802.83 feet, and whose long chord bears South 07°02'02" East a distance of 903.00 feet to a point for a corner hereof;
3. Following a curve turning to the right through an angle of 12°17'51", having a radius of 1802.83 feet, and whose long chord bears South 13°37'13" West a distance of 386.20 feet to a point for a corner hereof;
4. South 19°45'45" West a distance of 954.26 feet to a point for a corner hereof;

THENCE South 46°41'19" East a distance of 2779.58 feet to a point for a corner hereof;

THENCE South 46°41'19" East a distance of 2640.00 feet to a point for a corner hereof;

THENCE South 43°37'03" West a distance of 2460.91 feet to a point for a corner hereof;

THENCE North 47°06'39" West a distance of 2638.10 feet to the **POINT OF BEGINNING** containing 2574.64 acres more or less, and as shown on certified plat herewith.

**LESS AND EXCEPT**

Tract 1 – approximately 44.30 acres more or less as shown on plat herewith.

Tract 2 – approximately 10.81 acres more or less as shown on plat herewith.

Tract 3 - approximately 129.16 acres more or less as shown on plat herewith.

Note: Bearings, distances and acreage shown hereon are NAD 83, South Central Zone and are derived from GPS techniques. Iron Rods set are a 1/2 inch rod with plastic caps marked "INTREPID".

Surveyed by;

March 10, 2020

Sherman L. Posey, R.P.L.S.  
Job# 20-1080.



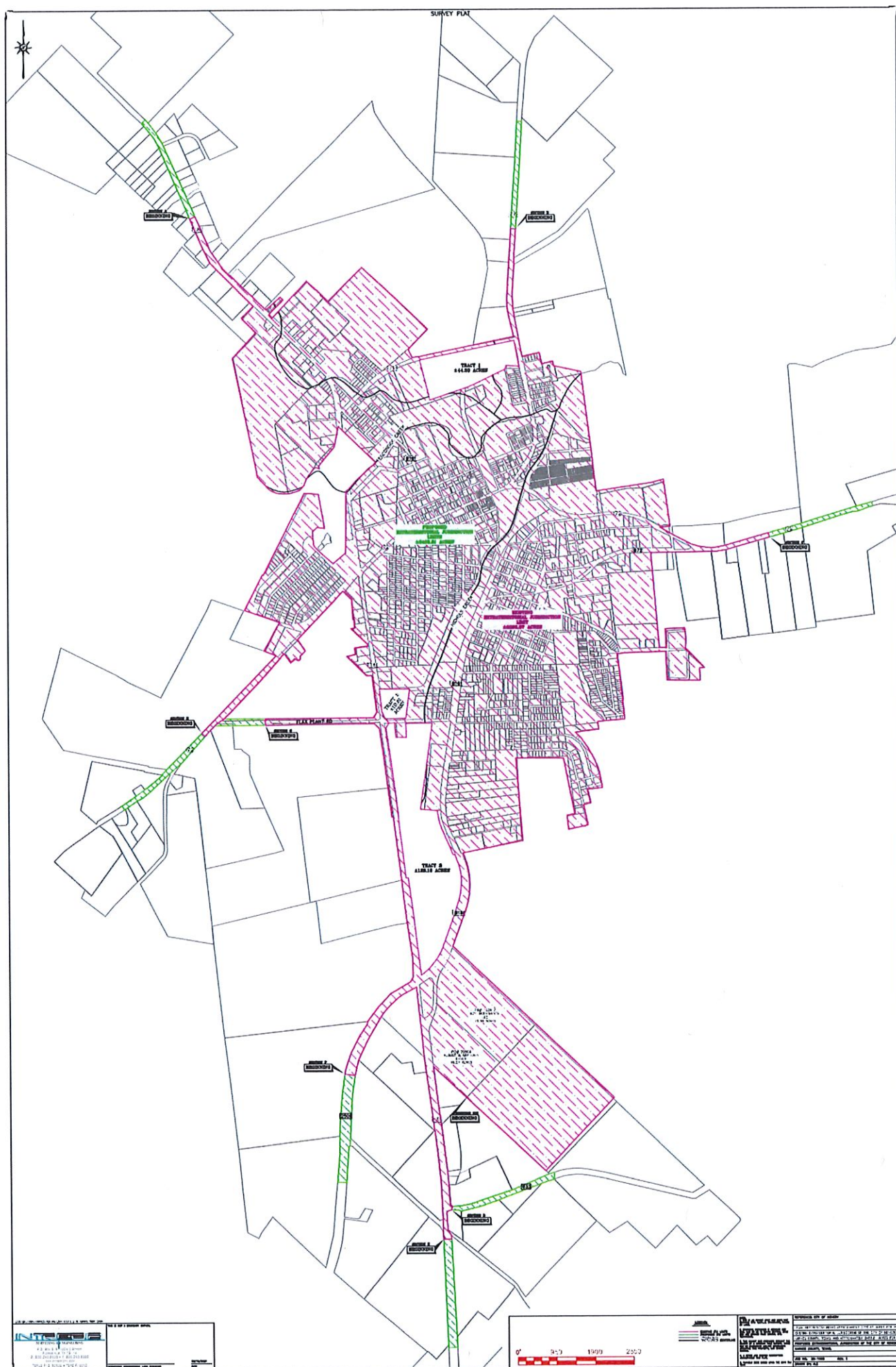



## SECTION A

**LEGAL DESCRIPTION:** Being 7.80 acres of land for the purpose of delineating a Defined Territory for Section A of the Proposed Extraterritorial Jurisdiction Limit in Kenedy, Karnes County, Texas:

**BEGINNING** in the southwest line of U. S. Highway No. 181 for the south corner hereof and from which a 5/8 inch iron rod found for the south corner of that certain PID# 70504 bears South 17°16'32" East a distance of 22547.54 feet;

**THENCE** along the southwest lines of U. S. Highway No. 181, the following 15 courses:

1. North 23°23'35" West a distance of 58.33 feet to a point for a corner hereof;
2. North 23°00'31" West a distance of 172.61 feet to a point for a corner hereof;
3. North 23°14'24" West a distance of 312.77 feet to a point for a corner hereof;
4. North 23°11'49" West a distance of 225.56 feet to a point for a corner hereof;
5. North 23°01'45" West a distance of 166.85 feet to a point for a corner hereof;
6. North 23°01'45" West a distance of 399.14 feet to a point for a corner hereof;
7. North 22°34'30" West a distance of 198.22 feet to a point for a corner hereof;
8. North 22°32'30" West a distance of 186.60 feet to a point for a corner hereof;
9. North 22°32'30" West a distance of 133.79 feet to a point for a corner hereof;
10. North 25°12'34" West a distance of 41.23 feet to a point for a corner hereof;
11. North 25°12'34" West a distance of 45.04 feet to a point for a corner hereof;
12. North 28°15'59" West a distance of 210.63 feet to a point for a corner hereof;
13. North 37°48'18" West a distance of 160.99 feet to a point for a corner hereof;
14. North 40°19'58" West a distance of 240.98 feet to a point for a corner hereof;
15. North 42°20'33" West a distance of 93.97 feet to a point for a corner hereof;

**THENCE** North 46°36'32" East a distance of 129.29 feet over and across U. S. Highway No. 181 to a point in the northeast line of U. S. Highway No. 181 for a corner hereof;

**THENCE** along the northeast lines of U. S. Highway No. 181, the following 11 courses:

1. South 43°23'28" East a distance of 106.47 feet to a point for a corner hereof;
2. South 37°40'46" East a distance of 311.52 feet to a point for a corner hereof;
3. South 31°23'55" East a distance of 290.83 feet to a point for a corner hereof;
4. South 25°15'12" East a distance of 80.08 feet to a point for a corner hereof;
5. South 23°34'02" East a distance of 719.00 feet to a point for a corner hereof;
6. South 23°49'28" East a distance of 212.00 feet to a point for a corner hereof;
7. South 23°50'48" East a distance of 209.92 feet to a point for a corner hereof;
8. South 23°50'49" East a distance of 221.27 feet to a point for a corner hereof;
9. South 23°50'49" East a distance of 80.63 feet to a point for a corner hereof;
10. South 23°50'49" East a distance of 233.24 feet to a point for a corner hereof;
11. South 23°50'49" East a distance of 222.31 feet to a point for a corner hereof;

**THENCE** South 66°09'11" West a distance of 141.86 feet over and across U. S. Highway No. 181 to the **POINT OF BEGINNING** containing 7.80 acres more or less, and as shown on certified plat herewith.

Note: Bearings, distances and acreage shown hereon are NAD 83, South Central Zone and are derived from GPS techniques. Iron Rods set are a 1/2 inch rod with plastic caps marked "INTREPID".

Surveyed by;

---

Sherman L. Posey, R.P.L.S.  
Job# 20-1080.

March 10, 2020





## SECTION B

**LEGAL DESCRIPTION:** Being 7.52 acres of land for the purpose of delineating a Defined Territory for Section B of the Proposed Extraterritorial Jurisdiction Limit in Kenedy, Karnes County, Texas:

**BEGINNING** at a point in the east line of Farm to Market Road No. 792 for the southeast corner hereof and from which a 5/8 inch iron rod found for the south corner of that certain PID# 70504 bears South 03°31'47" West a distance of 21293.47 feet;

THENCE North 86°15'19" West a distance of 120.72 feet over and across Farm to Market Road No. 792 to a point in the west line of Farm to Market Road No. 792 for a corner hereof;

THENCE along the west lines of Farm to Market Road No. 792, the following 4 courses:

1. North 03°01'31" East a distance of 627.32 feet to a point for a corner hereof;
2. North 04°10'45" East a distance of 987.85 feet to a point for a corner hereof;
3. North 02°38'32" East a distance of 138.55 feet to a point for a corner hereof;
4. North 03°00'29" East a distance of 886.42 feet to a point for a corner hereof;

THENCE South 86°53'18" East a distance of 123.81 feet over and across Farm to Market Road No. 792 to a point in the east line of Farm to Market Road No. 792 for a corner hereof;

THENCE along the east lines of Farm to Market Road No. 792, the following 2 courses:

1. South 03°06'42" West a distance of 1028.46 feet to a point for a corner hereof;
2. South 03°44'41" West a distance of 1612.93 feet to the **POINT OF BEGINNING** containing 7.52 acres more or less, and as shown on certified plat herewith.

Note: Bearings, distances and acreage shown hereon are NAD 83, South Central Zone and are derived from GPS techniques. Iron Rods set are a 1/2 inch rod with plastic caps marked "INTREPID".

Surveyed by;

March 10, 2020

Sherman L. Posey, R.P.L.S.  
Job# 20-1080.



## SECTION C

**LEGAL DESCRIPTION:** Being 6.45 acres of land for the purpose of delineating a Defined Territory for Section C of the Proposed Extraterritorial Jurisdiction Limit in Kenedy, Karnes County, Texas:

**BEGINNING** at a point in the south line of State Highway No. 72 for the southwest corner hereof and from which a 5/8 inch iron rod found for the south corner of that certain PID# 70504 bears South 28°45'02" West a distance of 15603.93 feet;

**THENCE** North 15°37'25" West a distance of 110.23 feet over and across State Highway No. 72 to a point in the north line of State Highway No. 72 for a corner hereof;

**THENCE** along the north lines of State Highway No. 72, the following 7 courses:

1. North 74°19'28" East a distance of 843.55 feet to a point for a corner hereof;
2. North 72°04'01" East a distance of 322.64 feet to a point for a corner hereof;
3. North 73°19'23" East a distance of 303.50 feet to a point for a corner hereof;
4. North 73°19'26" East a distance of 36.72 feet to a point for a corner hereof;
5. North 73°19'23" East a distance of 746.23 feet to a point for a corner hereof;
6. North 73°19'24" East a distance of 36.37 feet to a point for a corner hereof;
7. North 75°07'56" East a distance of 352.48 feet to a point for a corner hereof;

**THENCE** South 14°52'04" East a distance of 99.77 feet over and across State Highway No. 72 to a point in the south line of State Highway No. 72 for a corner hereof;

**THENCE** along the south lines of State Highway No. 72, the following 9 courses:

1. South 74°25'02" West a distance of 131.08 feet to a point for a corner hereof;
2. South 67°21'36" West a distance of 114.98 feet to a point for a corner hereof;
3. South 72°18'52" West a distance of 164.05 feet to a point for a corner hereof;
4. South 84°36'51" West a distance of 113.76 feet to a point for a corner hereof;
5. South 74°24'56" West a distance of 312.14 feet to a point for a corner hereof;
6. South 72°11'56" West a distance of 977.11 feet to a point for a corner hereof;
7. South 73°07'21" West a distance of 168.19 feet to a point for a corner hereof;
8. South 74°22'34" West a distance of 308.45 feet to a point for a corner hereof;
9. South 74°22'35" West a distance of 353.45 feet to the **POINT OF BEGINNING** containing 6.45 acres more or less, and as shown on certified plat herewith.

Note: Bearings, distances and acreage shown hereon are NAD 83, South Central Zone and are derived from GPS techniques. Iron Rods set are a 1/2 inch rod with plastic caps marked "INTREPID".

Surveyed by;

March 10, 2020

Sherman L. Posey, R.P.L.S.  
Job# 20-1080.

P.O. Box 519 ♦ 1004 C Street  
Floresville, TX 78114  
O. (830) 393-8833  
F. (830) 393-3388



## SECTION D

**LEGAL DESCRIPTION:** Being 7.56 acres of land for the purpose of delineating a Defined Territory for Section D of the Proposed Extraterritorial Jurisdiction Limit in Kenedy, Karnes County, Texas:

**BEGINNING** at a point in the south line of Farm to Market Road No. 632 for the southwest corner hereof and from which a 5/8 inch iron rod found for the south corner of that certain PID# 70504 bears North 08°10'28" East a distance of 2765.71 feet;

**THENCE** North 17°03'54" East a distance of 88.19 feet over and across Farm to Market Road No. 632 to a point in the north line of Farm to Market Road No. 632 for a corner hereof;

**THENCE** along the north lines of Farm to Market Road No. 632, the following 12 courses:

1. North 86°34'59" East a distance of 96.22 feet to a point for a corner hereof;
2. North 85°07'23" East a distance of 82.14 feet to a point for a corner hereof;
3. North 82°34'09" East a distance of 85.78 feet to a point for a corner hereof;
4. North 79°38'09" East a distance of 92.46 feet to a point for a corner hereof;
5. North 78°46'04" East a distance of 45.91 feet to a point for a corner hereof;
6. North 74°43'18" East a distance of 135.04 feet to a point for a corner hereof;
7. North 69°33'00" East a distance of 206.73 feet to a point for a corner hereof;
8. North 77°53'44" East a distance of 10.23 feet to a point for a corner hereof;
9. North 71°47'51" East a distance of 761.54 feet to a point for a corner hereof;
10. North 67°30'20" East a distance of 1001.70 feet to a point for a corner hereof;
11. North 74°27'58" East a distance of 31.23 feet to a point for a corner hereof;
12. North 72°06'41" East a distance of 102.36 feet to a point for a corner hereof;

**THENCE** South 00°30'13" West a distance of 163.26 feet over and across Farm to Market Road No. 632 to a point in the south line of Farm to Market Road No. 632 to a point for a corner hereof;

**THENCE** along the south lines of Farm to Market Road No. 632, the following courses:

1. South 72°06'41" West a distance of 36.23 feet to a point for a corner hereof;
2. South 74°27'58" West a distance of 141.00 feet to a point for a corner hereof;
3. South 71°33'19" West a distance of 113.43 feet to a point for a corner hereof;
4. South 68°21'33" West a distance of 26.78 feet to a point for a corner hereof;
5. South 68°21'33" West a distance of 209.22 feet to a point for a corner hereof;
6. South 71°08'13" West a distance of 164.21 feet to a point for a corner hereof;
7. South 68°23'41" West a distance of 194.69 feet to a point for a corner hereof;
8. South 70°14'36" West a distance of 313.94 feet to a point for a corner hereof;
9. South 68°17'42" West a distance of 259.82 feet to a point for a corner hereof;
10. South 70°44'46" West a distance of 475.75 feet to a point for a corner hereof;
11. South 76°14'22" West a distance of 494.24 feet to a point for a corner hereof;
12. North 60°56'43" West a distance of 55.35 feet to a point for a corner hereof;
13. North 88°27'09" West a distance of 185.73 feet to a point to the **POINT OF BEGINNING** containing 7.56 acres more or less, and as shown on certified plat herewith.

Note: Bearings, distances and acreage shown hereon are NAD 83, South Central Zone and are derived from GPS techniques. Iron Rods set are a 1/2 inch rod with plastic caps marked "INTREPID".

Surveyed by;

March 10, 2020

---

Sherman L. Posey, R.P.L.S.  
Job# 20-1080.





## SECTION E

**LEGAL DESCRIPTION:** Being 12.59 acres of land for the purpose of delineating a Defined Territory for Section E of the Proposed Extraterritorial Jurisdiction Limit in Kenedy, Karnes County, Texas:

**BEGINNING** at a point in the West line of U. S. Highway No. 181 for the northwest corner hereof and from which a 5/8 inch iron rod found for the south corner of that certain PID# 70504 bears North 09°35'40" East a distance of 3502.57 feet;

**THENCE** North 87°08'00" East a distance of 192.64 feet over and across U. S. Highway No. 181 to a point in the east line of U. S. Highway No. 181 for a corner hereof;

**THENCE** along the east lines of U. S. Highway No. 181, the following 3 courses:

1. South 02°52'00" East a distance of 1433.62 feet to a point for a corner hereof;
2. South 02°52'00" East a distance of 947.92 feet to a point for a corner hereof;
3. South 02°10'15" East a distance of 258.48 feet to a point for a corner hereof;

**THENCE** South 87°10'44" West a distance of 220.05 feet over and across U. S. Highway No. 181 to a point in the west line of U. S. Highway No. 181 for a corner hereof;

**THENCE** along the west lines of U. S. Highway No. 181 the following 2 courses:

1. North 02°12'14" West a distance of 1212.78 feet to a point for a corner hereof;
2. North 02°12'13" West a distance of 1427.22 feet to the **POINT OF BEGINNING** containing 12.59 acres more or less, and as shown on certified plat herewith.

Note: Bearings, distances and acreage shown hereon are NAD 83, South Central Zone and are derived from GPS techniques. Iron Rods set are a 1/2 inch rod with plastic caps marked "INTREPID".

Surveyed by;

March 10, 2020

Sherman L. Posey, R.P.L.S.  
Job# 20-1080.



## SECTION F

**LEGAL DESCRIPTION:** Being 14.77 acres of land for the purpose of delineating a Defined Territory for Section F of the Proposed Extraterritorial Jurisdiction Limit in Kenedy, Karnes County, Texas:

**BEGINNING** at a point in the West line of Farm to Market Road No. 2509 for the northwest corner hereof and from which a 5/8 inch iron rod found for the south corner of that certain PID# 70504 bears South 78°50'30" East a distance of 3035.48 feet;

**THENCE** South 81°33'55" East a distance of 254.67 feet over and across Farm to Market Road No. 2509 to a point in the east line of Farm to Market Road No 2509 for a corner hereof;

**THENCE** along the east lines of Farm to Market Road No. 2509, the following 6 courses:

1. South 08°56'09" West a distance of 449.66 feet to a point for a corner hereof;
2. South 03°08'36" West a distance of 1090.66 feet to a point for a corner hereof;
3. South 03°42'14" West a distance of 182.31 feet to a point for a corner hereof;
4. South 53°44'02" West a distance of 31.95 feet to a point for a corner hereof;
5. South 04°01'34" West a distance of 561.34 feet to a point for a corner hereof;
6. South 03°46'16" West a distance of 309.19 feet to a point for a corner hereof;

**THENCE** North 88°05'32" West a distance of 225.72 feet over and across Farm to Market Road No. 2509 to a point in the west line of Farm to market Road No. 2509 for a corner hereof;

**THENCE** along the west lines of Farm to Market Road No. 2509, the following 7 courses:

1. North 05°14'38" East a distance of 626.81 feet to a point for a corner hereof;
2. North 00°38'00" East a distance of 62.75 feet to a point for a corner hereof;
3. North 00°37'56" East a distance of 424.16 feet to a point for a corner hereof;
4. North 01°24'13" East a distance of 250.13 feet to a point for a corner hereof;
5. North 04°30'48" East a distance of 729.69 feet to a point for a corner hereof;
6. North 07°21'25" East a distance of 328.20 feet to a point for a corner hereof;
7. North 08°26'05" East a distance of 220.71 feet to the **POINT OF BEGINNING** containing 14.77 acres more or less, and as shown on certified plat herewith.

Note: Bearings, distances and acreage shown hereon are NAD 83, South Central Zone and are derived from GPS techniques. Iron Rods set are a 1/2 inch rod with plastic caps marked "INTREPID".

Surveyed by;

March 10, 2020

Sherman L. Posey, R.P.L.S.  
Job# 20-1080.



## SECTION G

**LEGAL DESCRIPTION:** Being 4.28 acres of land for the purpose of delineating a Defined Territory for Section G of the Proposed Extraterritorial Jurisdiction Limit in Kenedy, Karnes County, Texas:

**BEGINNING** at a point in the south line of Farm to Market Road No. 1145 for the southeast corner hereof and from which a 5/8 inch iron rod found for the south corner of that certain PID# 70504 bears South 28°12'00" East a distance of 10362.10 feet;

THENCE South 89°29'54" West a distance of 1244.25 feet along the south line of Farm to Market Road No. 1145 to a point in the southeast line of State Highway No. 72 for the southwest corner hereof;

THENCE along the southeast lines of State Highway No. 72, the following 3 courses:

1. North 44°02'12" East a distance of 70.60 feet to a point for a corner hereof;
2. North 56°36'26" East a distance of 202.47 feet to a point for a corner hereof;
3. North 45°29'20" East a distance of 8.45 feet to a point for a corner hereof;

THENCE North 89°50'42" East a distance of 1018.51 feet along the north line of Farm to Market Road No. 1145 to a point for a corner hereof;

THENCE South 00°33'18" East a distance of 159.98 feet over and across Farm to Market Road No. 1145 to the **POINT OF BEGINNING** containing 4.28 acres more or less, and as shown on certified plat herewith.

Note: Bearings, distances and acreage shown hereon are NAD 83, South Central Zone and are derived from GPS techniques. Iron Rods set are a 1/2 inch rod with plastic caps marked "INTREPID".

Surveyed by;

March 10, 2020

Sherman L. Posey, R.P.L.S.  
Job# 20-1080.





## SECTION H

**LEGAL DESCRIPTION:** Being 7.47 acres of land for the purpose of delineating a Defined Territory for Section H of the Proposed Extraterritorial Jurisdiction Limit in Kenedy, Karnes County, Texas:

**BEGINNING** at a point in the northwest line of State Highway No. 72 for the north corner hereof and from which a 5/8 inch iron rod found for the south corner of that certain PID# 70504 bears South 35°51'23" East a distance of 11027.37 feet;

**THENCE** South 48°12'24" East a distance of 109.22 feet over and across State Highway No. 72 to a point in the southeast line of State Highway No. 72 for a corner hereof;

**THENCE** along the southeast lines of State Highway No. 72, the following 8 courses:

1. South 41°47'36" West a distance of 863.44 feet to a point for a corner hereof;
2. South 48°21'26" West a distance of 386.55 feet to a point for a corner hereof;
3. South 47°06'43" West a distance of 674.63 feet to a point for a corner hereof;
4. South 51°01'02" West a distance of 215.24 feet to a point for a corner hereof;
5. South 60°45'02" West a distance of 168.94 feet to a point for a corner hereof;
6. South 55°13'58" West a distance of 278.04 feet to a point for a corner hereof;
7. South 57°00'58" West a distance of 64.57 feet to a point for a corner hereof;
8. South 55°57'56" West a distance of 28.96 feet to a point for a corner hereof;

**THENCE** North 34°02'04" West a distance of 113.00 feet over and across State Highway No. 72 to a point in the northwest line of State Highway No. 72 for a corner hereof;

**THENCE** along the northeast lines of State Highway No. 72, the following 9 courses:

1. North 55°35'10" East a distance of 424.91 feet to a point for a corner hereof;
2. North 52°51'00" East a distance of 261.85 feet to a point for a corner hereof;
3. North 52°50'55" East a distance of 167.60 feet to a point for a corner hereof;
4. North 51°49'59" East a distance of 183.49 feet to a point for a corner hereof;
5. North 50°02'43" East a distance of 179.24 feet to a point for a corner hereof;
6. North 10°36'29" East a distance of 27.96 feet to a point for a corner hereof;
7. North 42°53'25" East a distance of 182.79 feet to a point for a corner hereof;
8. North 44°04'25" East a distance of 303.68 feet to a point for a corner hereof;
9. North 44°26'24" East a distance of 923.23 feet to the **POINT OF BEGINNING** containing 7.47 acres more or less, and as shown on certified plat herewith.

Note: Bearings, distances and acreage shown hereon are NAD 83, South Central Zone and are derived from GPS techniques. Iron Rods set are a 1/2 inch rod with plastic caps marked "INTREPID".

Surveyed by;

March 10, 2020

Sherman L. Posey, R.P.L.S.  
Job# 20-1080.

P.O. Box 519 ♦ 1004 C Street  
Floresville, TX 78114  
O. (830) 393-8833  
F. (830) 393-3388